

LOSEY, JACKSON, MI, 49203

https://tuckerbenner.com

Parcel Report - Parcel ID: 5-2193.1000

1/19/2021

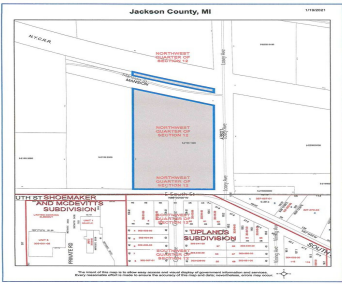

Commerical vacant land, perfect for your warehouse or storage lot. Lease/Sale/Seller financing available. 3.14 acres Will build to suit.

- 0 baths
- Commercial Land
- Land
- Active



Basics

Category: Land

Status: Active

Lot size: 3.14 sq ft

Lot Size Acres: 3.14 acres

Type: Commercial Land

Bathrooms: 0 baths

Subdivision Name: None

County: Jackson



Call us now

Phone: (231)730-8781

Email: tuckerbennerteam@gmail.com

Address: 2747 Lakeshore Drive, Twin Lake, MI 49457



Building Details

Current Use: Commercial

Amenities & Features

Lot Features: Buildable, Cleared

Fees & Taxes

Tax Assessed Value: \$39,181

Tax Year: 2021

Tax Annual Amount: \$2,717.35

School Information

High School District: Jackson

Miscellaneous

Road Surface Type: Paved

CrossStreet: corner of Losey and South St

Listing Terms: Cash, Build to Suit



Call us now

Phone: (231)730-8781

Email: tuckerbennerteam@gmail.com

Address: 2747 Lakeshore Drive, Twin Lake, MI 49457

