

PLEASANT VIEW, BROOKLYN, MI, 49230

https://tuckerbenner.com

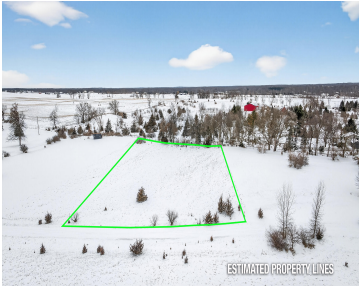

Looking to build, this 1.67-acre lot in Brooklyn may be the one! Columbia Central School District. Located off of Wolf Lake Rd, west on Pleasant View Ln. This parcel is on north side of Pleasant View Ln. See Building & Use Restrictions in associated docs. HOA fee is \$100 per year and covers road maintenance. [...]

- 0 baths
- Lot
- Land
- Active

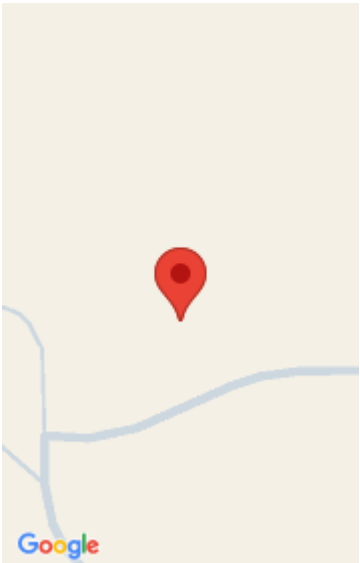

Basics

Category: Land

Status: Active

Lot size: 1.67 sq ft

Lot Size Acres: 1.67 acres

Type: Lot

Bathrooms: 0 baths

Subdivision Name: Pleasant View Lane

County: Jackson

Building Details

Current Use: Residential

Amenities & Features

Utilities: None

Lot Features: Buildable, Cleared

Fees & Taxes

Tax Assessed Value: \$3,098

Association Fee: \$100

Tax Annual Amount: \$147.22

Association Fee Frequency: Annually

Tax Year: 2025

Association Fee Includes: Other

School Information

High School District: Columbia

Miscellaneous

CrossStreet: Wolf lake Rd & Palmer Rd

Listing Terms: Cash, Conventional

Call us now