

# RAMBLEWOOD, COVERT, MI, 49043

https://tuckerbenner.com

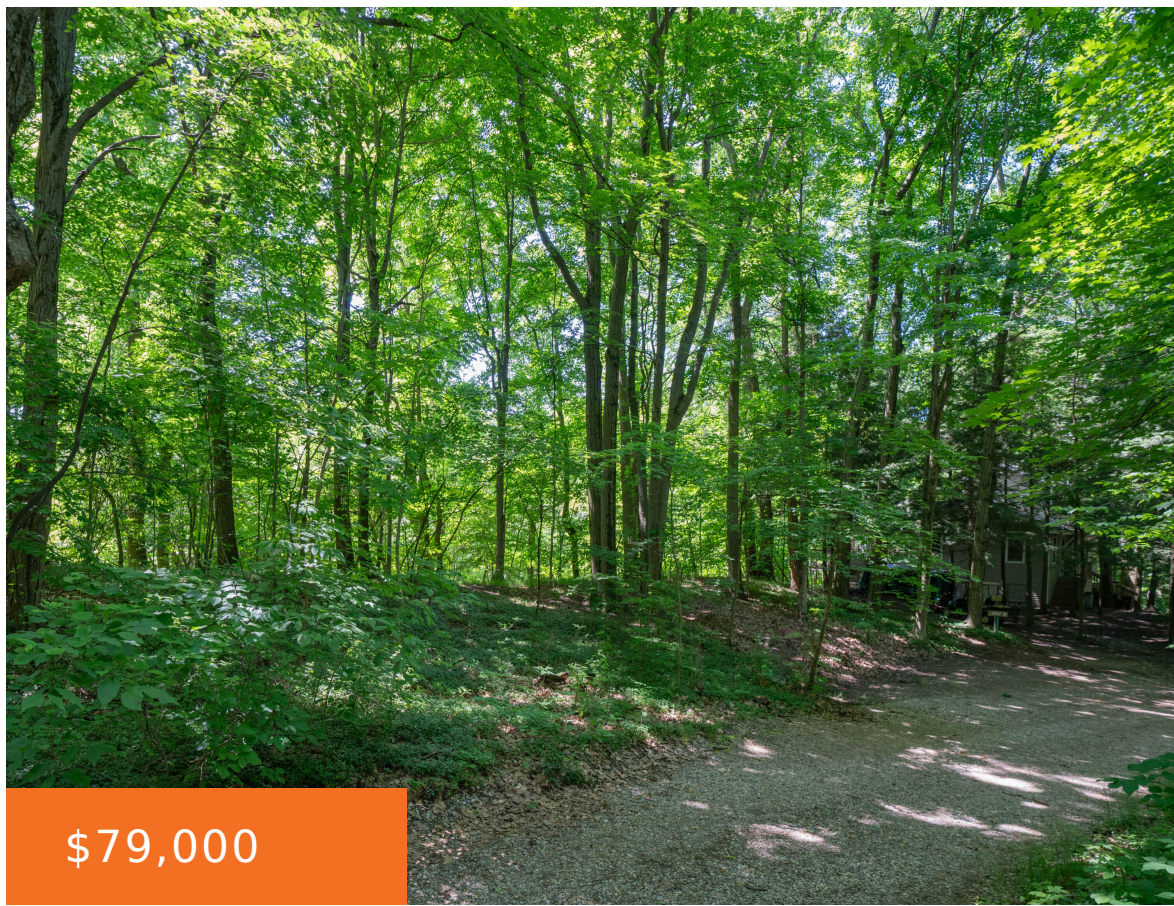

Find your oasis in Palisades Park, where relaxation and recreation meet. This double lot offers access to an array of amenities, including an association beach, clubhouse, tennis courts, and a soda bar. Picture yourself building your dream beach house just steps away from the pristine shores of Lake Michigan. From leisurely beach walks to lively [...]

- 0 baths
- Lot
- Land
- Active



## Basics

**Category:** Land

**Status:** Active

**Lot size:** 0.2 sq ft

**Lot Size Acres:** 0.2 acres

**Type:** Lot

**Bathrooms:** 0 baths

**Subdivision Name:** Palisades Park County Club

**County:** Van Buren



### Call us now

Phone: (231)730-8781

Email: tuckerbennerteam@gmail.com

Address: 2747 Lakeshore Drive, Twin Lake, MI 49457



---

## Amenities & Features

**Utilities:** None Connected, Phone Available, Public Water Available, Electric Available

**Waterfront Features:** All Sports, Assoc Access

**Association Amenities:** Clubhouse, Baseball Diamond, Beach Area, Pets Allowed, Restaurant/Bar, Storage, Tennis Court(s)

**Lot Features:** Rolling Hills, Buildable, Wooded

---

## Fees & Taxes

**Tax Assessed Value:** \$18,197

**Tax Year:** 2024

**Association Fee Frequency:** Annually

**Tax Annual Amount:** \$836.03

---

## School Information

**High School District:** Covert

---

## Miscellaneous

**Road Surface Type:** Unimproved

**Listing Terms:** Cash, Conventional

**CrossStreet:** Ramblewood Dr



### Call us now

Phone: (231)730-8781

Email: [tuckerbennerteam@gmail.com](mailto:tuckerbennerteam@gmail.com)

Address: 2747 Lakeshore Drive, Twin Lake, MI 49457

