

ROSEHILL, JACKSON, MI, 49202

https://tuckerbenner.com

PARCEL DATA SHEET - PARCEL ID: 000-08-26-102-011-01



\$199,900

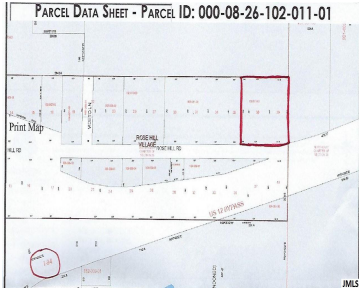

Just over 2 acres of land along a busy stretch of I-94. Great prep site for rebuild on Interstate 94. Easy access from two on/off ramps one at Elm Rd and the other at Cooper M106

- 0 baths
- Acreage
- Land
- Active



Basics

Category: Land
Status: Active
Lot size: 2.11 sq ft
Lot Size Acres: 2.11 acres

Type: Acreage
Bathrooms: 0 baths
Subdivision Name: Village of Rose Hill
County: Jackson



Call us now

Phone: (231)730-8781
 Email: tuckerbennerteam@gmail.com
 Address: 2747 Lakeshore Drive, Twin Lake, MI 49457



Amenities & Features

Lot Features: Cleared

Fees & Taxes

Tax Assessed Value: \$6,300

Tax Year: 2021

Tax Annual Amount: \$356.02

School Information

High School District: Jackson

Miscellaneous

Road Surface Type: Paved

CrossStreet: Elm and Cooper

Listing Terms: Cash, Conventional



Call us now

Phone: (231)730-8781

Email: tuckerbennerteam@gmail.com

Address: 2747 Lakeshore Drive, Twin Lake, MI 49457

