

TOMPKINS, RIVES JUNCTION, MI, 49277

<https://tuckerbenner.com>

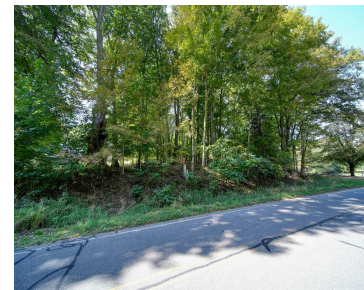
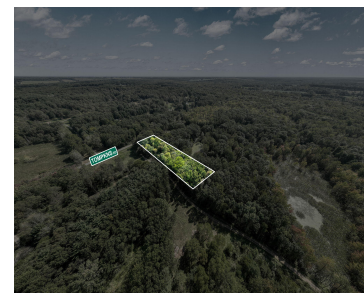
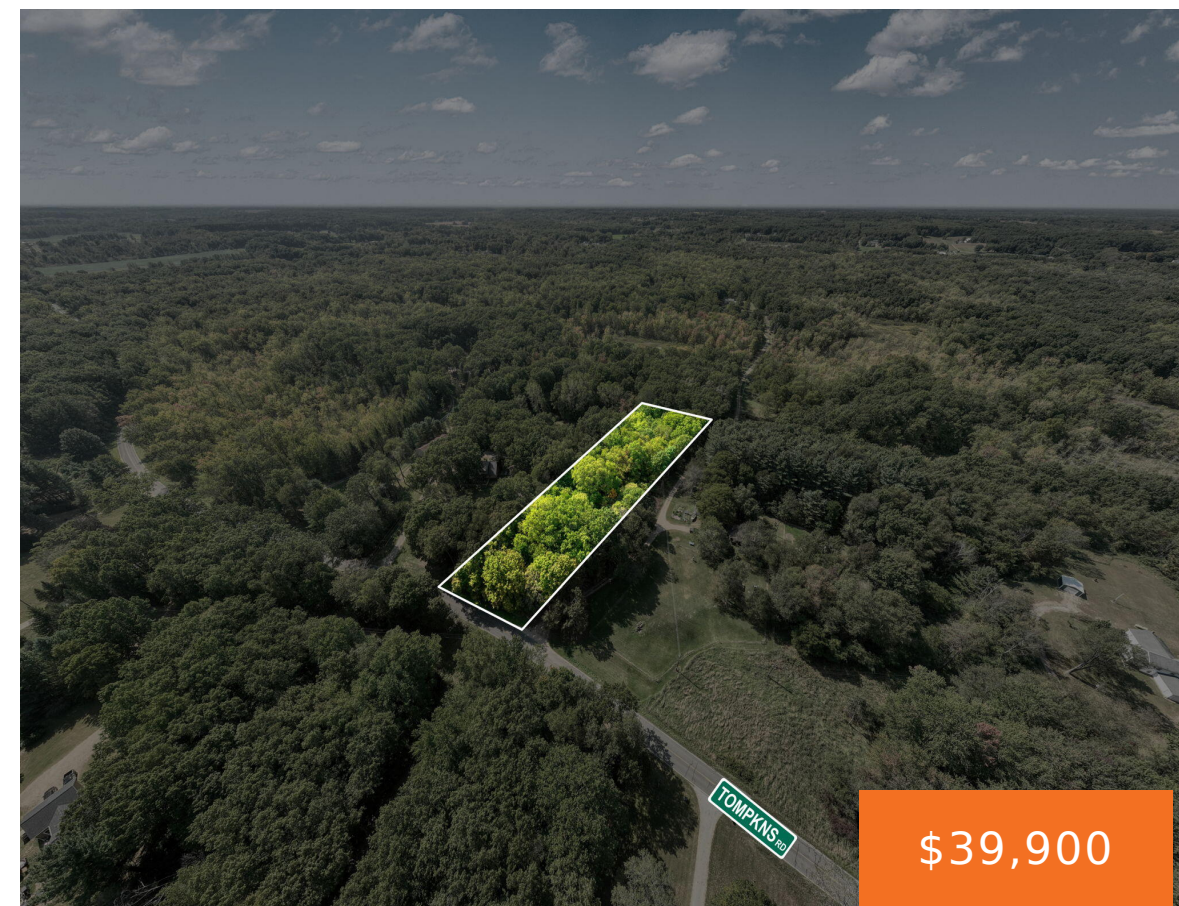

Thinking of building a dream home or owning a piece of recreational property? This beautiful 2.91-acre wooded parcel is the perfect canvas. Surrounded by lush wildlife you'll enjoy the peace and privacy this land offers. It's an ideal piece of property for those that love the outdoors. Whether you envision a private retreat or a [...]

- 0 baths
- Acreage
- Land
- Active



Basics

Category: Land

Status: Active

Lot size: 2.91 sq ft

County: Jackson

Type: Acreage

Bathrooms: 0 baths

Lot Size Acres: 2.91 acres



Call us now

Phone: (231)730-8781

Email: tuckerbennerteam@gmail.com

Address: 2747 Lakeshore Drive, Twin Lake, MI 49457



Building Details

Current Use: Recreational

Amenities & Features

Utilities: Electricity Available, None

Lot Features: Recreational, Wooded

Fees & Taxes

Tax Assessed Value: \$4,366

Tax Year: 2024

Tax Annual Amount: \$201

School Information

High School District: Northwest

Miscellaneous

Road Surface Type: Paved

CrossStreet: Dove Lane

Listing Terms: Cash, Conventional



Call us now

Phone: (231)730-8781

Email: tuckerbennerteam@gmail.com

Address: 2747 Lakeshore Drive, Twin Lake, MI 49457

