

WHITEHALL, WHITEHALL, MI, 49461

<https://tuckerbenner.com>



\$35,000

This beautiful .93 acre (40,510 sq ft) partially wooded lot on Whitehall Rd with 294 feet of road frontage is the perfect place! The bike/walking trail allows you to travel to Muskegon or North to Hart for miles and miles of fun! Located in Fruitland Township, with easy access to US-31, the possibilities are endless. [...]

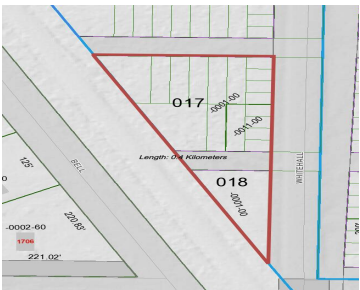

- 0 baths
- Acreage
- Land
- Active

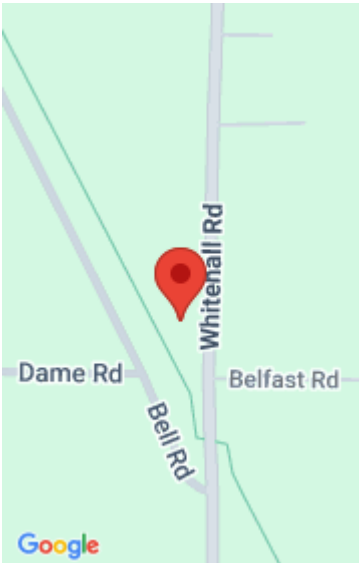

Basics

Category: Land

Status: Active

Lot size: 0.93 sq ft

County: Muskegon

Type: Acreage

Bathrooms: 0 baths

Lot Size Acres: 0.93 acres

Amenities & Features

Utilities: None

Fees & Taxes

Tax Assessed Value: \$98,000

Tax Year: 2024

Tax Annual Amount: \$99

School Information

High School District: Reeths-Puffer

Miscellaneous

CrossStreet: Whitehall Rd & Belfast

Listing Terms: Cash, Conventional

Call us now