

WHITEHALL, MUSKEGON, MI, 49445

<https://tuckerbenner.com>

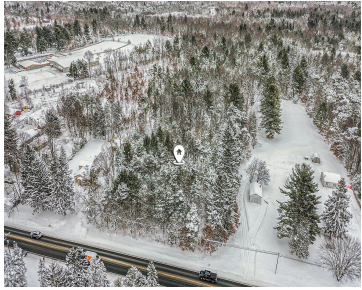
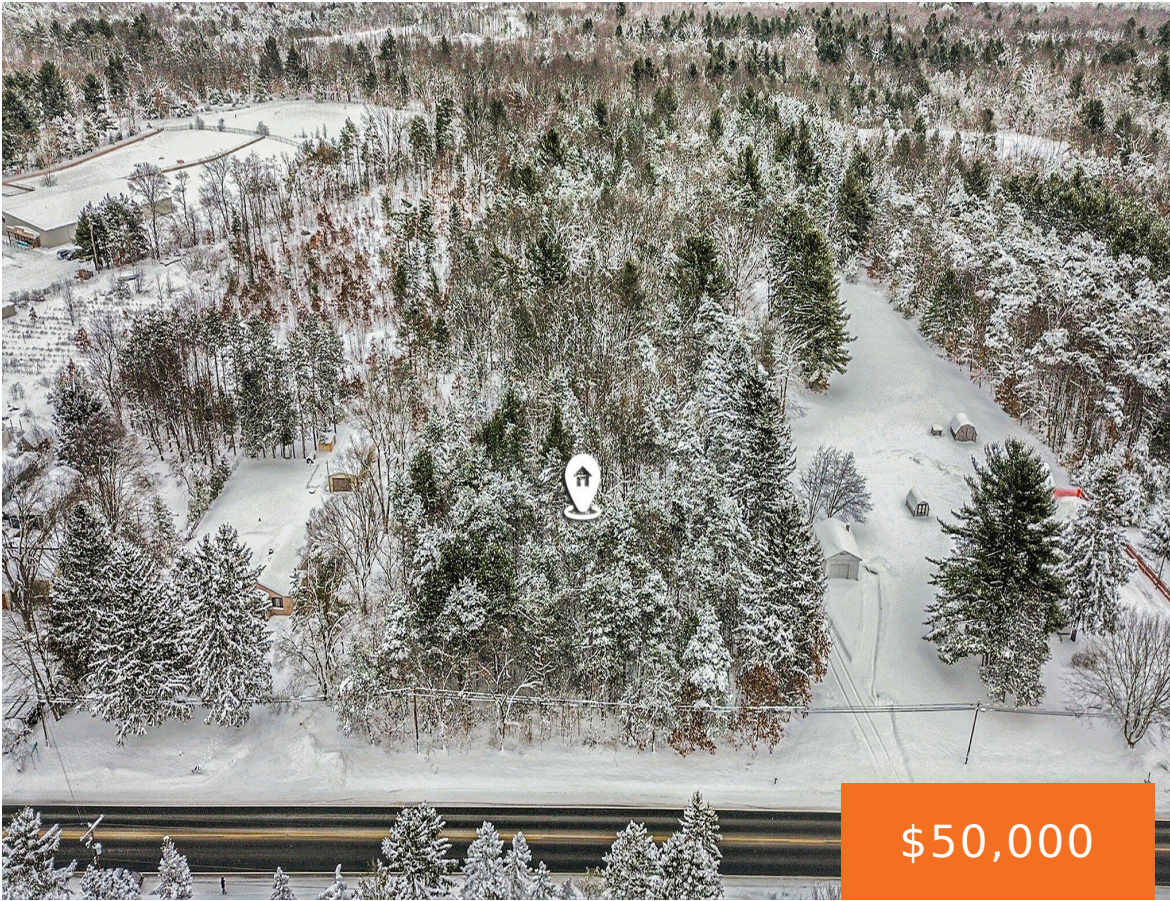

Discover an exceptional 5.27-acre property on Whitehall Road in Dalton Township, offering 200 feet of road frontage and endless possibilities for your dream home, investment, or development project. This wooded parcel provides privacy while remaining conveniently close to the highway and local amenities. Essential utilities, including broadband, cable, electricity, natural gas, public sewer, and water, [...]

- 0 baths
- Acreage
- Land
- Active



Basics

Category: Land

Status: Active

Lot size: 5.27 sq ft

County: Muskegon

Type: Acreage

Bathrooms: 0 baths

Lot Size Acres: 5.27 acres



Call us now

Phone: (231)730-8781
 Email: tuckerbennerteam@gmail.com
 Address: 2747 Lakeshore Drive, Twin Lake, MI 49457



Amenities & Features

Utilities: Water Available, Sewer Available, Broadband, None

Lot Features: Level, Buildable, Wooded

Fees & Taxes

Tax Assessed Value: \$16,162

Tax Year: 2024

Tax Annual Amount: \$833.93

School Information

High School District: Reeths-Puffer

Miscellaneous

Road Surface Type: Paved

CrossStreet: Duck Lake Rd & Bard Rd

Listing Terms: Cash, Conventional



Call us now

Phone: (231)730-8781

Email: tuckerbennerteam@gmail.com

Address: 2747 Lakeshore Drive, Twin Lake, MI 49457

