

VL WINTERS, WHITMORE LAKE, MI, 48189

https://tuckerbenner.com

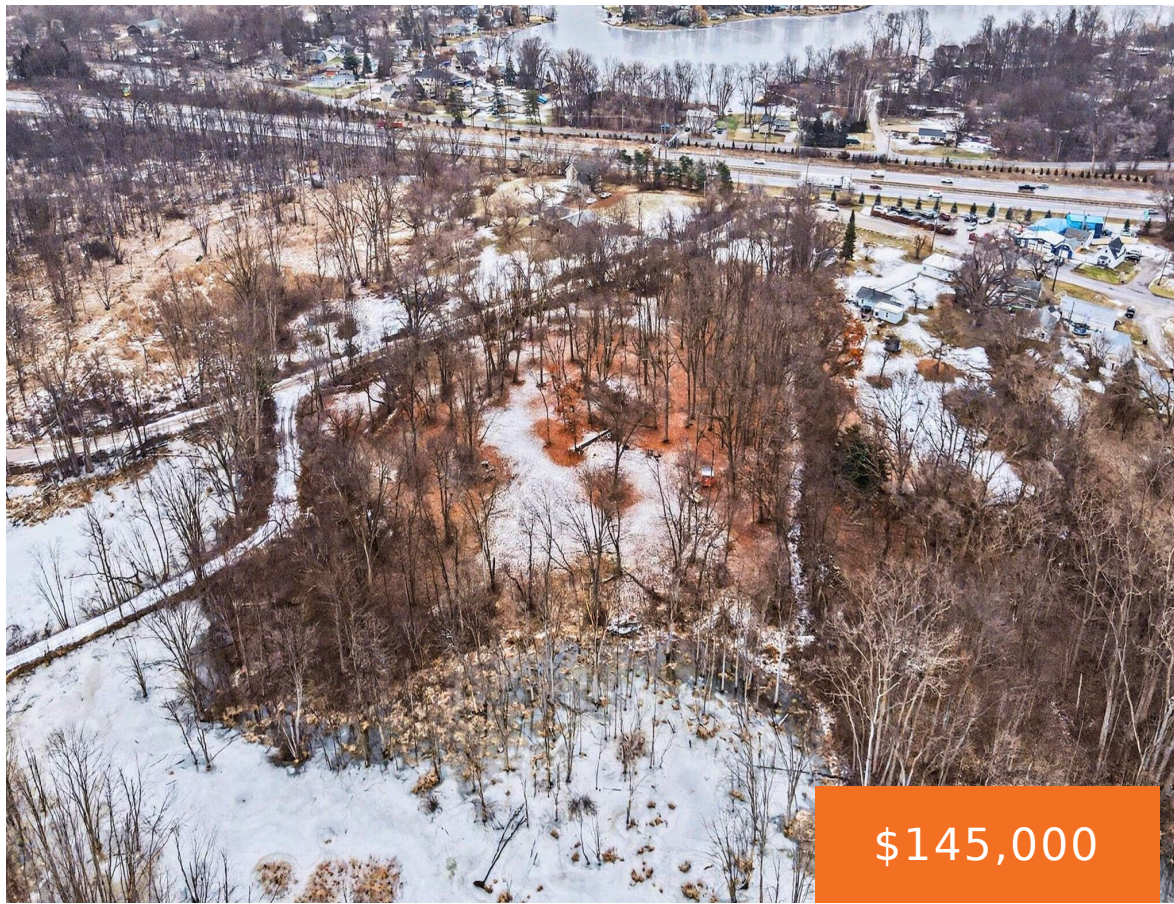

Discover a rare five-acre vacant parcel set along Winters Lane in Whitmore Lake, Michigan. This impressive corner lot boasts approximately 601 feet of road frontage along Winters Lane, complemented by an additional approximately 34 feet of frontage on Coyle Road, creating a commanding presence from multiple approaches. Expansive frontage and wide-open acreage combine to deliver [...]

- 0 baths
- Acreage
- Land
- Active



Basics

Category: Land
Status: Active
Lot size: 5 sq ft
County: Washtenaw

Type: Acreage
Bathrooms: 0 baths
Lot Size Acres: 5 acres

Call us now



Phone: (231)730-8781
 Email: tuckerbennerteam@gmail.com
 Address: 2747 Lakeshore Drive, Twin Lake, MI 49457



Amenities & Features

Utilities: Electricity Available, None

Lot Features: Level, Wooded, Corner Lot

Fees & Taxes

Tax Assessed Value: \$45,467

Tax Year: 2025

Tax Annual Amount: \$2,721

School Information

High School District: Whitmore Lake

Miscellaneous

Road Surface Type: Paved

CrossStreet: Winters Lane & Coyle Rd

Listing Terms: Cash, Conventional

Call us now



Phone: (231)730-8781

Email: tuckerbennerteam@gmail.com

Address: 2747 Lakeshore Drive, Twin Lake, MI 49457

