

WATERWHEEL, SIX LAKES, MI, 48886

<https://tuckerbenner.com>

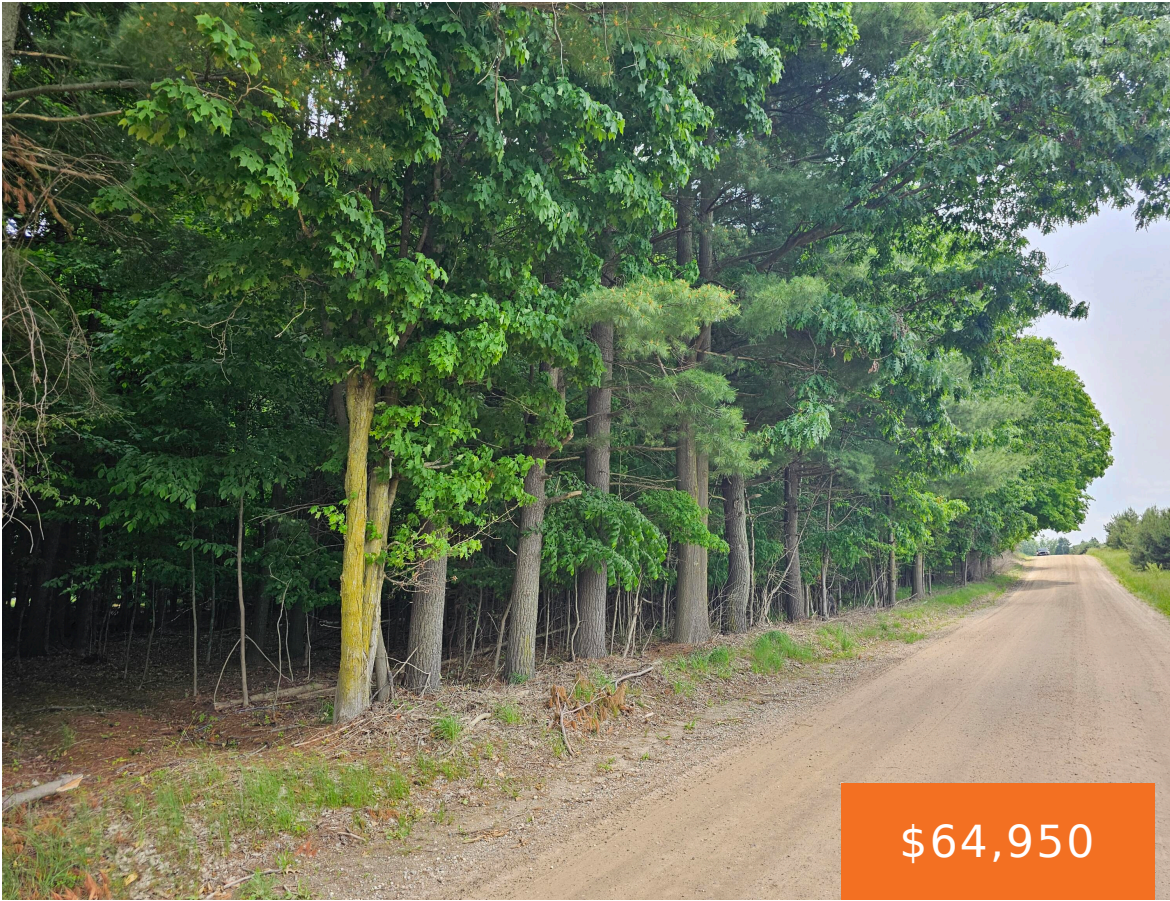

6 beautiful wooded, buildable acres in Lakeview School District. Land Contract terms available.

- 0 baths
- Acreage
- Land
- Active



Basics

Category: Land
Status: Active
Lot size: 6 sq ft
County: Montcalm

Type: Acreage
Bathrooms: 0 baths
Lot Size Acres: 6 acres



Call us now

Phone: (231)730-8781
 Email: tuckerbennerteam@gmail.com
 Address: 2747 Lakeshore Drive, Twin Lake, MI 49457



Amenities & Features

Utilities: None

Fees & Taxes

Tax Assessed Value: \$20,000

Tax Year: 2025

Tax Annual Amount: \$500

School Information

High School District: Lakeview-Montcalm Co

Miscellaneous

CrossStreet: Plumb

Listing Terms: Cash, VA Loan, Conventional, Contract



Call us now

Phone: (231)730-8781

Email: tuckerbennerteam@gmail.com

Address: 2747 Lakeshore Drive, Twin Lake, MI 49457

