

2685, ASHFORD, PORTAGE, MI, 49024  
https://tuckerbenner.com

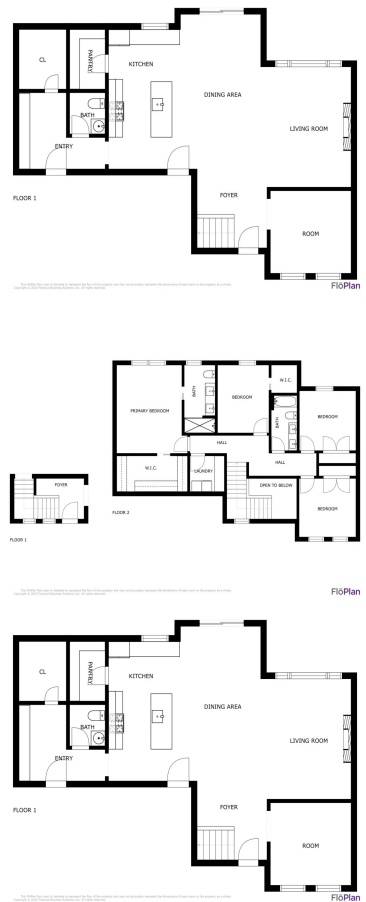

Striking new modern farmhouse by TMR Builders offering 4 BR's, 2.5 baths and over 2,400 sq. ft. of finished living space! Soaring 2 story foyer leads to den (or formal dining room) off entryway. Open concept design features the great room w/ FP, large dining area & kitchen w/ center island & walk in pantry. [...]

- 4 beds
- 3 baths
- Single Family Residence
- Residential
- Active
- 2415 sq ft

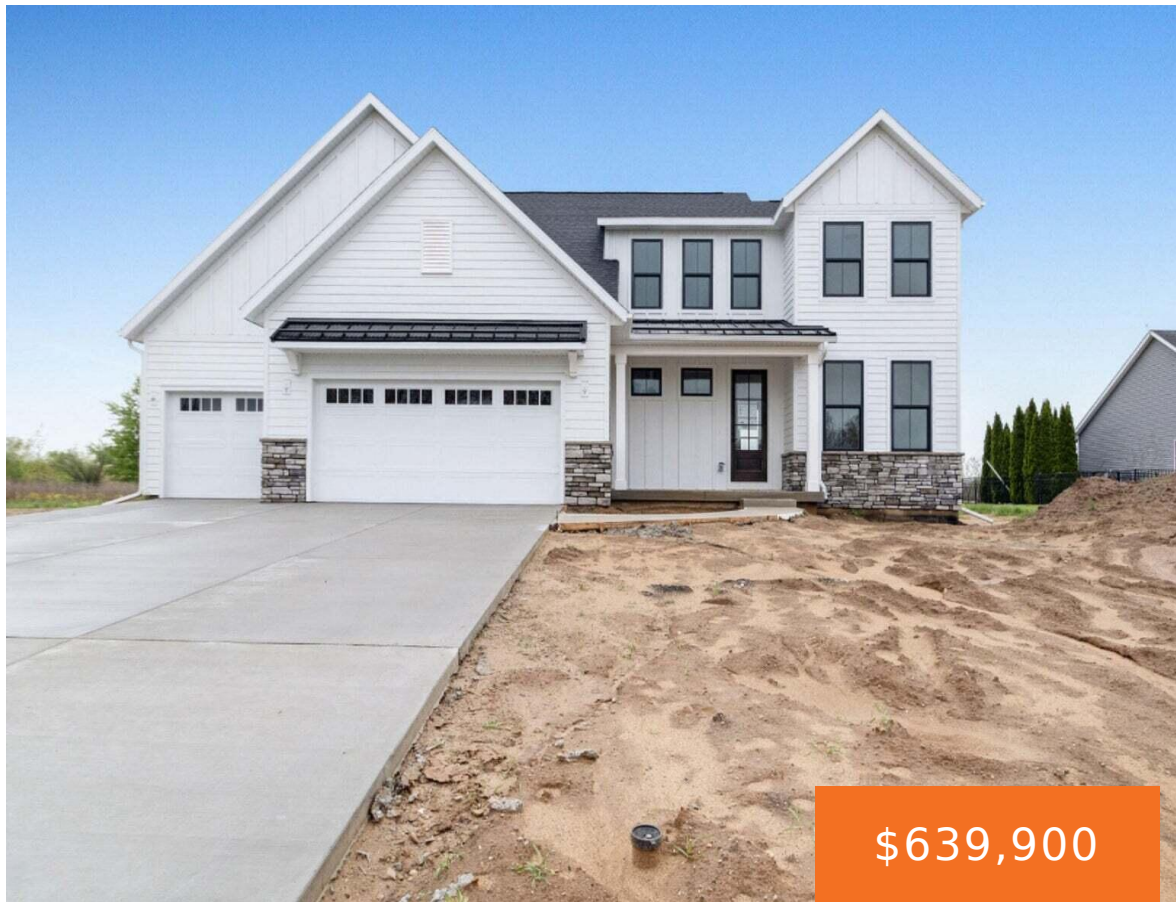

Call us now

Phone: (231)730-8781  
Email: tuckerbennerteam@gmail.com  
Address: 2747 Lakeshore Drive, Twin Lake, MI 49457

# Basics

**Category:** Residential

**Status:** Active

**Bathrooms:** 3 baths

**Lot size:** 0.3 sq ft

**Subdivision Name:** Oakland Farms

**Lot Size Acres:** 0.3 acres

**County:** Kalamazoo

**Type:** Single Family Residence

**Bedrooms:** 4 beds

**Area:** 2415 sq ft

**Year built:** 2025

**Bathrooms Full:** 2

**Rooms Total:** 9

**Bathrooms Half:** 1

# Building Details

**Building Area Total:** 2415 sq ft

**Construction Materials:** Stone, Vinyl Siding

**Architectural Style:** Traditional

**Sewer:** Public

**Heating:** Forced Air

**Stories:** 2

**Roof:** Composition

**Basement:** Full

# Amenities & Features

**Laundry Features:** Laundry Room, Upper Level

**Parking Features:** Garage Faces Front, Garage Door Opener, Attached

**Garage Spaces:** 3

**Interior Features:** Garage Door Opener, Center Island, Eat-in Kitchen, Pantry

**Patio And Porch Features:** Patio, Porch(es)

**Flooring:** Carpet, Other, Tile

**Fireplace Features:** Gas Log, Living Room

**WaterSource:** Public

**Window Features:** Low-Emissivity Windows, Screens

**Cooling:** Central Air

# Fees & Taxes

**Tax Assessed Value:** \$1,750

**Tax Year:** 2025

Call us now



---

# School Information

**High School District:** Portage

---

# Miscellaneous

**Road Surface Type:** Paved

**CrossStreet:** Honey Creek Trail &  
Windflower

**Listing Terms:** Cash, FHA, VA Loan, Conventional

**Call us now**