

416, MICHIGAN, MANTON, MI, 49663

https://tuckerbenner.com

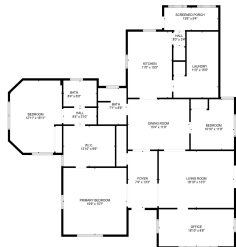

\$250,000



There is nearly 3500 sq feet of living space in this historic gem situated in the heart of Manton. Two bedrooms on the main floor with an additional non-conforming room, potential office or walk in closet off the primary bedroom. Open kitchen, large dining room and living room make this a great space to enjoy [...]

- 5 beds
- 4 baths
- Single Family Residence
- Residential
- Active
- 3549 sq ft

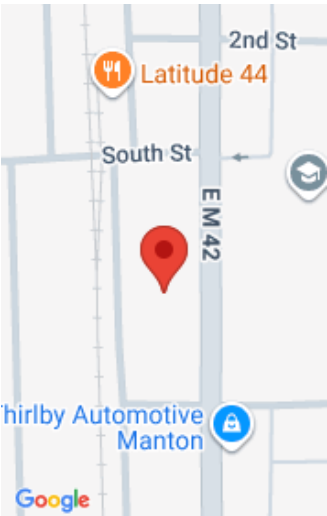

Call us now

Phone: (231)730-8781  
Email: tuckerbennerteam@gmail.com  
Address: 2747 Lakeshore Drive, Twin Lake, MI 49457

# Basics

<b>Category:</b> Residential	<b>Type:</b> Single Family Residence
<b>Status:</b> Active	<b>Bedrooms:</b> 5 beds
<b>Bathrooms:</b> 4 baths	<b>Area:</b> 3549 sq ft
<b>Lot size:</b> 0.41 sq ft	<b>Year built:</b> 1900
<b>Bathrooms Full:</b> 4	<b>Lot Size Acres:</b> 0.41 acres
<b>Rooms Total:</b> 13	<b>County:</b> Wexford

# Building Details

<b>Building Area Total:</b> 3232 sq ft	<b>Construction Materials:</b> Vinyl Siding, Wood Siding
<b>Architectural Style:</b> Craftsman	<b>Sewer:</b> Public Sewer
<b>Heating:</b> Forced Air, Radiant	<b>Stories:</b> 2
<b>Basement:</b> Crawl Space, Partial	

# Amenities & Features

<b>Laundry Features:</b> Electric Dryer Hookup, In Basement, Laundry Closet, Laundry Room, Main Level	<b>Fireplace Features:</b> Living Room
<b>WaterSource:</b> Public	<b>Appliances:</b> Washer, Refrigerator, Oven, Microwave, Dryer
<b>Interior Features:</b> Guest Quarters, Eat-in Kitchen, Pantry	<b>Lot Features:</b> Level
<b>Window Features:</b> Screens, Garden Window(s)	<b>Exterior Features:</b> Balcony, Other, Porch(es), Deck(s)
<b>Fireplaces Total:</b> 1	

# Fees & Taxes

Call us now



**Tax Assessed Value:** \$92,720  
**Tax Annual Amount:** \$5,600

**Tax Year:** 2024

**School Information**

**High School District:** Manton

**Miscellaneous**

**Road Surface Type:** Paved

**CrossStreet:** Michigan Ave

**Listing Terms:** Cash, Conventional

**Call us now**